

# PRECISION POWER

A PRECISION GROUP COMPANY

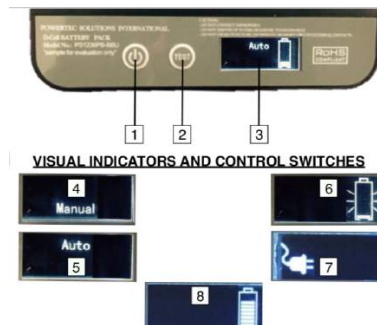

USER'S MANUAL FOR  
**PRECISION POWER D-Cell BBU**  
  
MODEL NUMBER: PPBBU-12



CONTROL SWITCHES			
1 "ON/OFF"	Primary Function: Push to activate battery backup during loss and VAC voltage in outage scenario. NOTE: DCell BBU must be in "Manual" Mode. If LED Indicator Window is not illuminated, then "ON/OFF" must be depressed 2x in order to activate or deactivate battery backup. Secondary Function: Push and Release to illuminate LED Indicator Window.		
2 TEST	Primary Function: Push and Release to illuminate LED Indicator Window. Secondary Function: Push and hold depressed for 15 seconds to toggle between "Manual" and "Auto" Modes		
VISUAL INDICATORS			
3 LED Indicator Window	When illuminated, displays visual indicator LED's		
4 "Manual" Mode	When illuminated, indicates DCell BBU is in "Manual Mode"		
5 "Auto" Mode	When illuminated, indicates DCell BBU is in "Manual Mode"		
6 "On Battery"	When illuminated, indicates DCell BBU is active and using DCell batteries for power output		
7 "On AC Power"	When illuminated, indicates DCell BBU is inactive and all VAC voltage is present. *Normal Operation		
8 "Battery Life"	When illuminated, indicates remaining battery life		
VISUAL AND AUDIBLE STATUS/ALARM SIGNALS			
STATE	VISUAL INDICATOR	AUDIBLE INDICATOR	DESCRIPTION
Low Battery	N/A	1/2 second audible indicator 4 times per minute	Battery has reached equal to or less than 30% remaining capacity on battery discharge.

## WARNING

Review the following important safety warnings to avoid bodily injury or damage to equipment during installation or operation of the device. Read ALL instructions before attempting to install or operate this device.

- Review the following important safety warnings to avoid bodily injury or damage to equipment during installation or operation of this device. Read ALL instructions before attempting to install or operate this device.
- This device is intended for indoor use only. To prevent the risk of fire or electrical shock, install in dry location free from damp or wet environment, or potentially damp or wet environment.
- Adhere to all acceptable operating environment limitations as listed to prevent the risk of fire or electrical shock (see user specifications within User's Manual)
- Risk of fire or explosion if improper battery is installed and attempted to operate with this device. Device is rated and approved for use with standard or rechargeable Alkaline DCell Battery ONLY. Follow User Manual instructions for proper installation and removal of Alkaline batteries.

**NOTE:** The reference to "DCell BBU" within this User Manual refers to Precision Power Model PPBBU-12 and all package accessories as listed below.

### CONTENTS OF DCell BBU PACKAGE

**NOTE:** Please verify all standard contents are accounted for upon receipt of DCell BBU.  
**STANDARD:** (1) DCell BBU with Cover (preassembled); (1) 3.5mm to 3.5mm Cable; (1) Wall Mountable Back Plate (1) User's Manual

**OPTIONAL ACCESSORIES:** Premade Vdc Output Cable. PLEASE CHECK WITH MANUFACTURER FOR ACCEPTABLE PART NUMBERS AND AVAILABILITY

**PLEASE NOTE: WITH STANDARD PACKAGING, BATTERIES NOT INCLUDED.**

### DCELL BBU INTRODUCTION

DCell BBU is designed and intended for use as Desktop or Wall-mount 12Vdc battery back up device for 12Vdc Optical Network Terminals (ONT). The DCell BBU can be used as "stand alone" battery backup to ONT during loss of Vac voltage to ONT, or can be partnered with Precision Power PP36PB-12B for uninterruptible service to indoor or outdoor ONT. Please refer to "Installation" portion of this User's Manual for proper connection to PP36PB-12B or direct connection to ONT.



FIGURE #1



FIGURE #2



FIGURE #3



FIGURE #4

### INSTALLATION

A. Remove all contents from DCell BBU packaging and confirm all Standard Contents are present as stated in "Contents of DCell BBU Package".

B. IF WALL MOUNTING: Locate Precision Power Model PP36PB-12B (FIGURE #4) and using provided DCell BBU Back Plate (FIGURE #5), position within 2 feet of either side of the PP36PB-12B. Utilizing screw mounting positions on back plate, mount back plate securely to the wall (Screws and Drywall Anchors NOT PROVIDED). NOTE: When unpacking the DCell BBU, the back plate will already be connected to the DCell BBU. Simply slide DCell BBU up and separate DCell BBU from wall mountable back plate.

C. FOR DESKTOP OR FLOOR INSTALLATION (NOT WALL MOUNTING): Skip Step "B". Utilize FIGURE #6 to begin installation of D-Cell Alkaline Batteries (NOT INCLUDED). Make sure that battery orientation follows the example shown in FIGURE #6. Negative Terminal of D-Cell Battery should always contact with DCell BBU "Springs". Never install Negative terminal of D-Cell Battery in with orientation to contact opposing Negative terminal of another D-Cell Battery in line. Never install Positive terminal of D-Cell Battery in with orientation to contact opposing Positive terminal of another D-Cell Battery in line.

D. Close cover of DCell BBU and ensure that cover "snaps" and is securely fastened.

E. Connect provided DCell BBU Cable (FIGURE #2) to DCell BBU Output Port (FIGURE #1).

## INSTALLATION (CONTINUED)

F. Connect opposing end of DCell BBU Cable (FIGURE #2) to Precision Power Model PP36PB-12B DCell BBU Input Port (FIGURE #4). NOTE: IT IS ASSUMED THAT PRECISION POWER MODEL PP36PB-12B IS ALREADY INSTALLED AND OPERATIONAL. IF NOT INSTALLED, PLEASE REFER TO USER'S AND INSTALLATION MANUAL FOR THE PP36PB-12B PRIOR TO INSTALLATION OF THE DCELL BBU.

G. Press "Test" Control Button 1x to ensure that "On AC" indicator LED, "Manual" Mode Indicator and "Battery Life" indicator LEDs are present. This confirms DCell BBU is working under normal operation and will indicate remaining battery capacity (i.e. battery life) of the installed D-Cell Alkaline Batteries. If these LED's are not present, please review "Trouble Shooting DCell BBU" section of this User's Manual.

H. IF WALL MOUNTING: Slide the DCell BBU onto already installed wall mountable back plate. To install, align DCell BBU left and right sides with the wall mounted back plate's left and right sides. Next, align DCell BBU "male" slide rails with wall mounted back plate's "female" slide rails and slide DCell BBU down into place securing to wall mounted back plate.

I. IF DESKTOP OR FLOOR INSTALLATION: Align DCell BBU "male" slide rails with wall mountable back plate's "female" slide rails and slide DCell BBU down into place securing to wall mounted back plate.

## OPERATION

A. DCell BBU will be preset to "Manual" Mode upon completion of installation and activation. In Manual Mode, the DCell BBU must be manually turned on when lose of AC Voltage in order to power customer premise device(s) by D-Cell Battery output. To activate DCell BBU, press the "ON/OFF" Button 2x, unless LED indicator window is already illuminated. If LED indicator window is already illuminated, then press the "ON/OFF" Button 1x only. The "ON BATTERY" LED Indicator should flash (see #6 from "Visual Indicator Section of this User's Manual).

B. Whether Programmed to "Manual" or "Auto" Mode, the DCell BBU will automatically deactivate "ON BATTERY" DC output when AC voltage is reestablished and present.

C. To initiate "Auto" Mode, press and hold "Test" Button for 15 seconds. "Auto" LED indicator will illuminate and "Manual" LED indicator will turn off. When in "Auto" Mode, the DCell BBU will automatically switch to "ON BATTERY" when AC Voltage is lost.

## BATTERY REPLACEMENT

1. Open the DCell BBU Cover and remove all D-Cell Alkaline Batteries. Following Installation "Step C, D and G." for installation and testing of new D-Cell Alkaline Batteries.

**NOTE: Please follow all State, Federal, and International Regulations when disposing of Alkaline Batteries**

## TROUBLE SHOOTING

Following proper installation of the DCell BBU as defined within this User's Manual, use below as recommendations for trouble shooting DCell BBU.

A. Confirm Precision Power Model PP36PB-12B and DCell BBU are connected securely with provided DCell BBU Cable (FIGURE #2)

B. Confirm Precision Power Model PP36PB-12B is securely plugged in to standard, working AC wall outlet or surge protector. \*For Trouble Shooting Precision Power Model PP36PB-12B, refer to PP36PB-12B User's and Installation Manual.

C. Press "Test" Control Button 1x to ensure that "On AC Power" indicator, "Manual" Mode Indicator and "Battery Life" indicator LEDs are present. This confirms DCell BBU is working under normal operation and will indicate remaining battery capacity (i.e. battery life) of the installed D-Cell Alkaline Batteries.

D. If no LED indicators are illuminated:

I. Ensure D-Cell Alkaline Batteries are installed correctly and securely II. Ensure provided DCell BBU Cable is installed securely to the DCell BBU and Precision Power Model PP36PB-12B

E. If DCell BBU is "beeping" (audible alarm), please change ALL installed D-Cell Alkaline Batteries with new batteries.

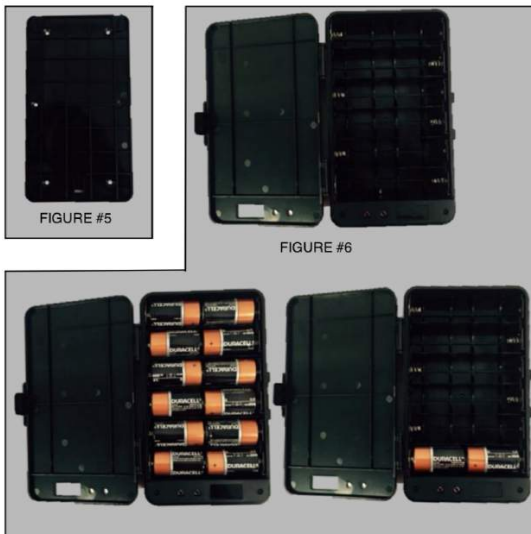

**PRECISION POWER**  
A PRECISION GROUP COMPANY

Authorized Partner  
**CORE** TELECOM SYSTEMS  
A PRECISION POWER COMPANY

**Core Telecom Systems**  
(888) 375-8826  
sales@coretelecom.net  
www.coretelecom.net